

## METAL PLUG ANCHOR-For Aerated Concrete

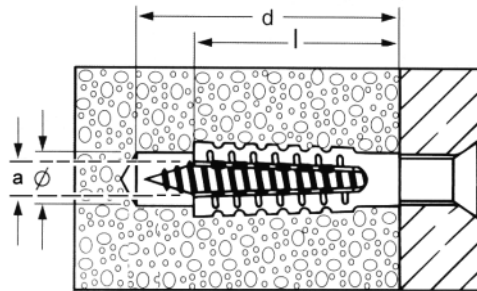

Code NO.	Plug Size	Anchor Length l (mm)	Dill Ø (mm)	Minimum Anchoring Depth d (mm)	Range of Applied Screw Diameters a (mm)	Qty / Box (pcs)
MPA0530	5x30	30	6-8	35	4.5	100
MPA0632	6x32	32	7-9	38	4.5~5.0	100
MPA0838	8x38	38	10-12	46	5.0~6.0	100
MPA0860	8x60	60	10-12	68	5.0~6.0	100
MPA1060	10x60	60	12-14	68	6.0~8.0	100

### Installation

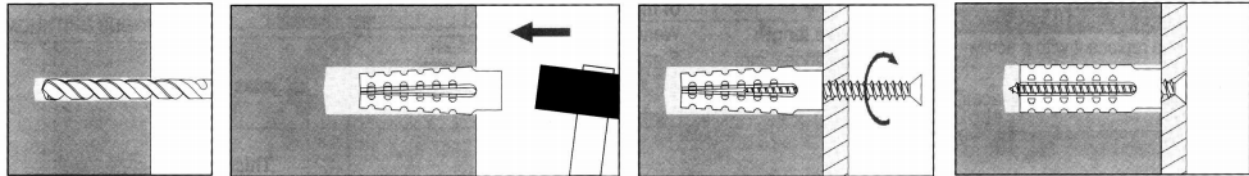

## STEEL MASON ANCHOR



Code No.	Size *	Anchor/Hole Diameter	Thread Size *	Anchor Length	Safe Tension Loads (kN)**	Quantity Per Box
1200	1/4"(M6)	1/2"	1/4"BSW	32mm	2.6	100
1202	5/16"(M8)	5/8"	5/16"BSW	50mm	6.2	50
1204	3/8"(M10)	5/8"	3/8"BSW	50mm	6.2	50
1206	1/2"(M12)	7/8"	1/2"BSW	65mm	9.2	25

\* The thread also can be in **METRIC**.

\*\* Loads are for concrete over 20Mpa quality brickwork and some sto

## FIXING BAND



Code No.	Size *	Thickness mm	Anchor Length
HL12A	12mm	1mm	10 m
HL17A	17mm	1mm	10 m
HL20A	20mm	1mm	10 m
HL25A	25mm	1mm	10 m
HL12B	12mm	0.75 mm	10 m
HL19B	19mm	0.75mm	10 m

\* Plastic coated is available

